

- EXCAVATE FOR LEVEL BASE TO A LENGTH ADEQUATE FOR REINFORCEMENT DESIGN LENGTH.
- SET GRADING STAKES AT A 0.50 FT OFFSET TO FACILITATE PROPER BASKET ALIGNMENT.
- EMBED BOTTOM BASKET AT FACE OF RSS AS SHOWN ON RSS PROFILE.

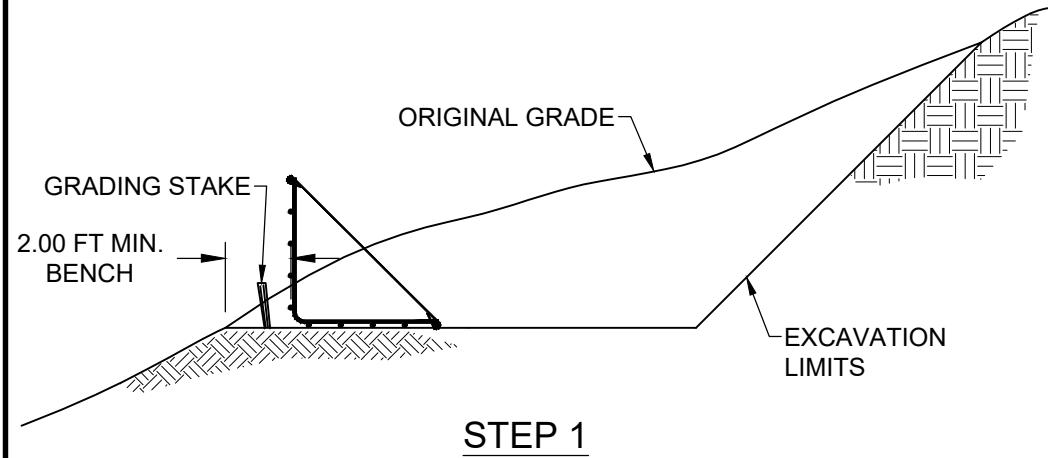

**STEP 1**

- FOR THE FIRST COURSE OF THE WALL, ALIGN BASKETS WITHOUT SPACES.
- INSTALL STRUTS AT 2.00 FT SPACING OR AS REQUIRED.

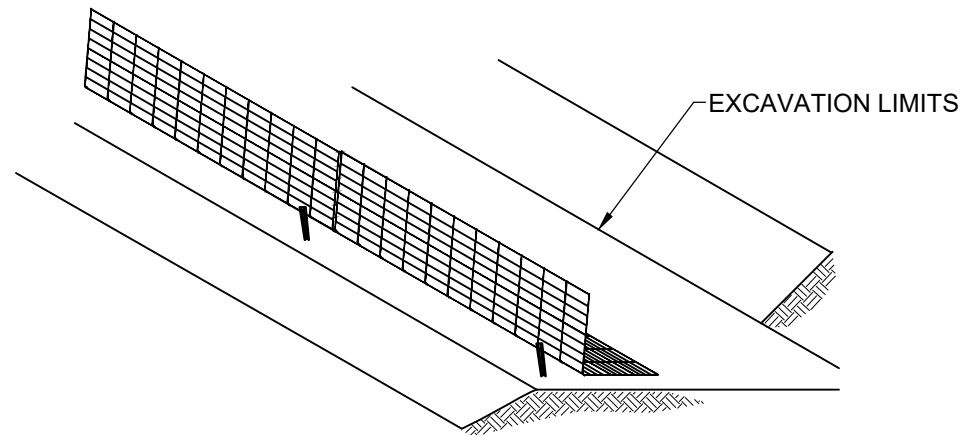

**STEP 2**

- PLACE MIRAMESH FACING WRAP ALLOWING FOR MINIMUM BOTTOM LENGTH OF 3.25 FT.
- DRAPE MIRAMESH OVER BASKET ALLOWING FOR THE REQUIRED WRAP LENGTH (MIN 3.25 FT EMBEDMENT).
- PLACE PRIMARY SOIL REINFORCEMENT AT ELEVATIONS AS SHOWN IN PROFILE DRAWING AND STOP AT THE FACE OF THE FORM.
- INSTALL STRUTS AT REQUIRED SPACING (2-FT MAX).

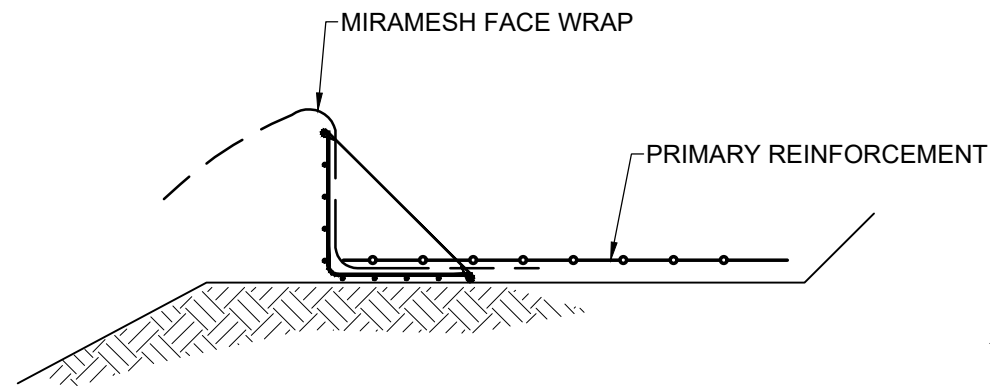

**STEP 3**

- BACKFILL CAREFULLY TO ABOUT 1" - 2" ABOVE THE TOP HORIZONTAL BASKET WIRE OR AS REQUIRED BY SPECIFICATION IN 9" LIFTS.
- COMPACT TO REQUIRED DENSITY.

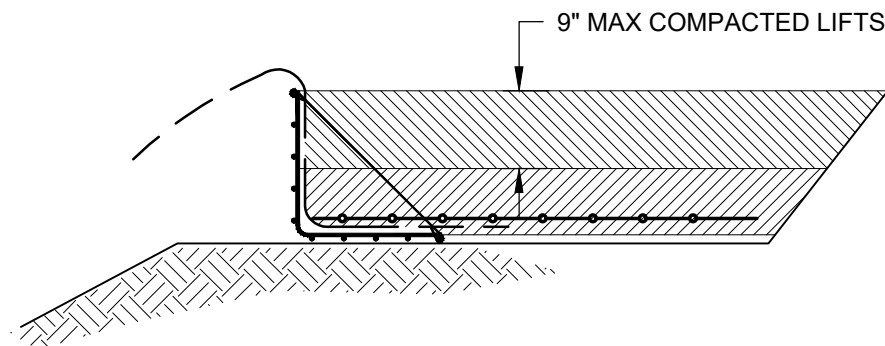

**STEP 4**

- PULL MIRAMESH FACING WRAP OVER COMPACTED FILL AND ANCHOR WITH SOIL.
- PLACE THE NEXT BASKET TO PROPER SETBACK BEHIND THE LOWER BASKET USING RUNNING BOND INSTALLATION (STAGGERED).

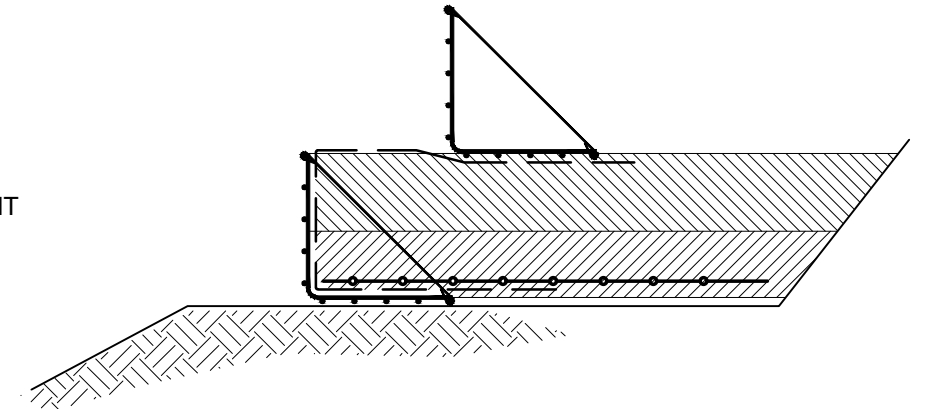

**STEP 5**

- REPEAT STEPS 2 THRU 5 UNTIL DESIRED HEIGHT OF WALL IS REACHED.

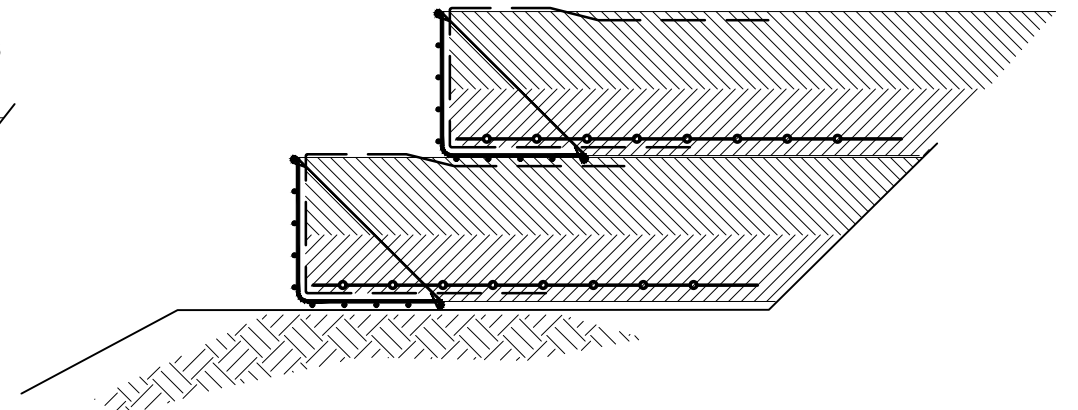

**STEP 6**



365 SOUTH HOLLAND DRIVE  
PENDERGRASS, GEORGIA 30567  
TEL: (706) 693-2226  
WWW.TENCATEGEO.US

NOTE: THE STANDARD DETAILS ILLUSTRATED IN THESE DRAWINGS ARE FOR INFORMATION AND EVALUATION PURPOSES ONLY AND ARE NOT FOR CONSTRUCTION. PROJECT SPECIFIC CALCULATIONS, SHOP DRAWINGS AND SPECIFICATIONS, SIGNED AND SEALED BY A STATE REGISTERED LICENSED ENGINEER, ARE REQUIRED FOR CONSTRUCTION.

## REINFORCED SOIL SLOPE WELDED WIRE MESH RSS DETAILS

STANDARD DETAIL NOT FOR CONSTRUCTION	WWM FACE INSTALLATION	SHEET W4	OF 10
DATE : 4/24/19			